

1	2
Corpo del raccordo Fitting Body Corps du raccord Verschraubungskörper	Guarnizioni Seals Joint d'étanchéité Dichtung
Ottone UNI EN 12164 CW614N - UNI EN 12165 CW617N Nichelato Brass UNI EN 12164 CW614N - UNI EN 12165 CW617N Nickel Plated Laiton UNI EN 12164 CW614N - UNI EN 12165 CW617N Nickelé Messing UNI EN 12164 CW614N - UNI EN 12165 CW617N vernickelt	NBR NBR NBR NBR

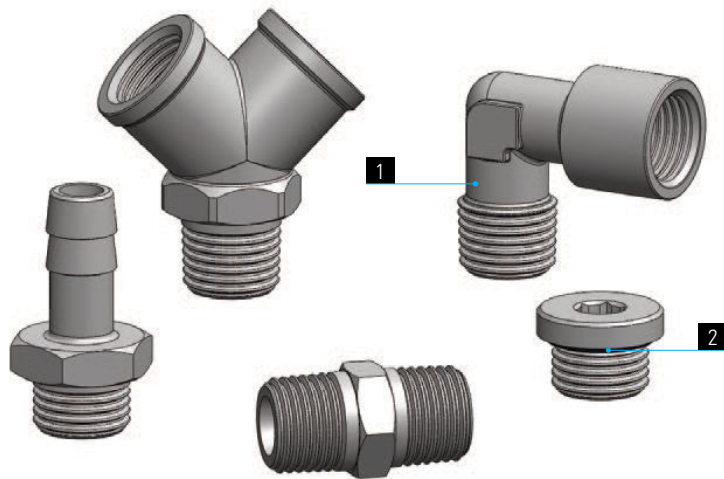
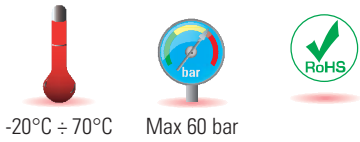

	M5x0,8	G1/8	G1/4	G3/8	G1/2	G3/4	G1"	R1/8	R1/4	R3/8	R1/2	R3/4	R1"
	●	●	●	●	●	●	●	●	●	●	●	●	●

Campi di applicazione:
 Impianti pneumatici, idraulici ed oleodinamici.

Application fields:
 Pneumatic, hydraulic and oleodynamic circuits.

Domaines d'application:
 Circuits pneumatiques, hydrauliques et oléodynamiques.

Anwendungsbereiche:
 Hydraulische, öldynamische und pneumatische Anlagen.

RA 40

Y F-F-F

Female Y

Y avec filetage intérieur

Y mit Innengewinde

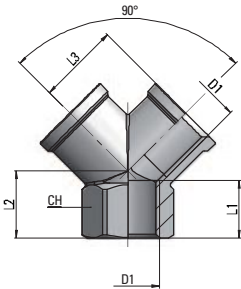

Tipo	D1	L1	L2	L3	CH	g	Δ
40 00 18	G1/8	8	12	14	13	18	
40 00 14	G1/4	11	14	17	17	33	
40 00 38	G3/8	11,5	16	19	20	44	
40 00 12	G1/2	14	19	24,5	25	93	

RA 41

Y M-F-F

Male Female Y

Y avec filetage intérieur/extérieur

Y mit Innen-Aussgewinde

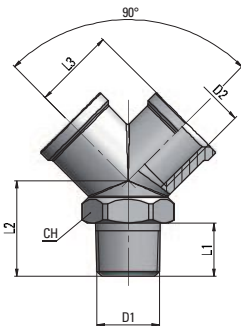

Tipo	D1	D2	L1	L2	L3	CH	g	Δ
41 00 18	R1/8	G1/8	8	16	14	13	22	
41 00 14	R1/4	G1/4	11	20	17	17	38	
41 00 38	R3/8	G3/8	11,5	22	19	20	53	
41 00 12	R1/2	G1/2	14	27	24,5	25	108	

RA 42

Anello filettato

Single Banjo Ring

Bague orientable simple

Einfaches Schwenkringstück

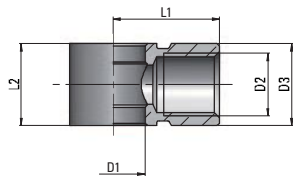

Tipo	D1	D2	D3	L1	L2	g	Δ
42 00 M5	5,1	M5x0,8	9	11,5	10	7	
42 00 M5/R	7	M5x0,8	9	11,5	10	6	
42 00 18	10	G1/8	14	16	15	15	
42 00 14	13,2	G1/4	17	22	17	25	
42 00 38	17	G3/8	20	26	20	40	
42 00 12	21	G1/2	26	32	24	66	

/R = Solo per regolatori di flusso - For flow controls only- Seulement pour les réducteurs de débit - Nur für Drosselrückschlagventil

RA 44

Passaparete Filettato

Bulkhead Connector

Traversée en cloison

Schottverschraubung

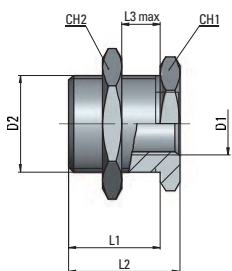

Tipo	D1	D2	L1	L2	L3max	CH1	CH2	g	Δ
44 00 M5	M5x0,5	M10x1	10,5	14	7	14	14	12	
44 00 18	G1/8	M16x1,5	14	18	8	19	22	29	
44 00 14	G1/4	M20x1,5	20	24	13	24	27	48	
44 00 38	G3/8	M26x1,5	21	26	13	30	32	91	
44 00 12	G1/2	M28x1,5	27	33	19	32	36	112	