

1	2
<p>Corpo del raccordo Fitting Body Corps du raccord Verschraubungskörper</p> <p>Ottone UNI EN 12164 CW614N - UNI EN 12165 CW617N Nichelato Brass UNI EN 12164 CW614N - UNI EN 12165 CW617N Nickel Plated Laiton UNI EN 12164 CW614N - UNI EN 12165 CW617N Nickelé Messing UNI EN 12164 CW614N - UNI EN 12165 CW617N vernickelt</p>	<p>Guarnizioni Seals Joint d'étanchéité Dichtung</p> <p>NBR NBR NBR NBR</p>

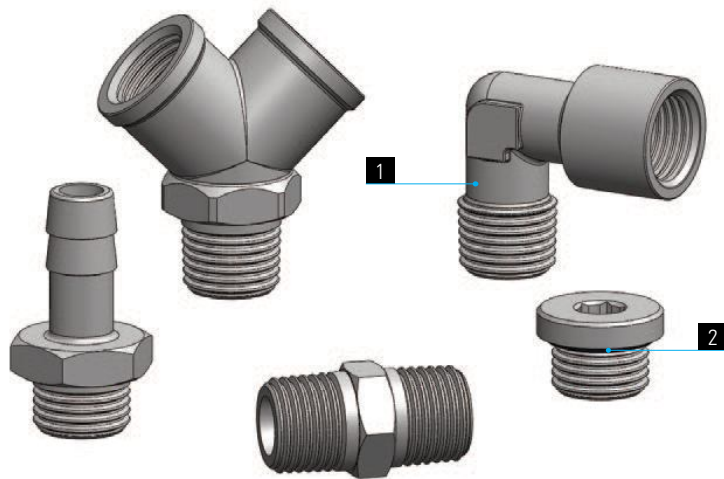
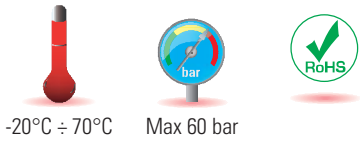

	M5x0,8	G1/8	G1/4	G3/8	G1/2	G3/4	G1"	R1/8	R1/4	R3/8	R1/2	R3/4	R1"
	●	●	●	●	●	●	●	●	●	●	●	●	●

Campi di applicazione:
Impianti pneumatici, idraulici ed oleodinamici.

Application fields:
Pneumatic, hydraulic and oleodynamic circuits.

Domaines d'application:
Circuits pneumatiques, hydrauliques et oléodynamiques.

Anwendungsbereiche:
Hydraulische, öldynamische und pneumatische Anlagen.

RA 11

Nipplo Cilindrico

Nipple, parallel

Mamelon cylindrique

Doppelnippel, zylindrisch

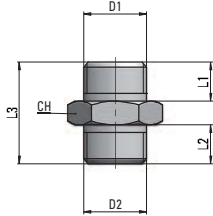

Tipo	D1	D2	L1	L2	L3	CH	g	△
11 M5 M5	M5x0,8	M5x0,8	5	5	13,5	8	2	
11 M5 18	M5x0,8	G1/8	5	6	15,5	14	8	
11 18 18	G1/8	G1/8	6	6	16,5	14	8	
11 18 14	G1/8	G1/4	6	8	19	17	14,5	
11 18 38	G1/8	G3/8	6	9	20	19	19	
11 14 14	G1/4	G1/4	8	8	21	17	16	
11 14 38	G1/4	G3/8	8	9	22	19	21	
11 14 12	G1/4	G1/2	8	10	23,5	24	32	
11 38 38	G3/8	G3/8	9	9	23	19	22	
11 38 12	G3/8	G1/2	9	10	24,5	24	35	
11 12 12	G1/2	G1/2	10	10	25,5	24	35	

RA 12

Nipplo Conico

Nipple, taper

Mamelon conique

Doppelnippel, kegelig

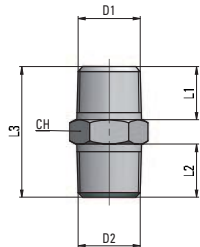

Tipo	D1	D2	L1	L2	L3	CH	g	△
12 18 18	R1/8	R1/8	7,5	7,5	20	12	8	
12 18 14	R1/8	R1/4	7,5	11	23,5	14	12	
12 18 38	R1/8	R3/8	7,5	11,5	24	17	20	
12 14 14	R1/4	R1/4	11	11	27	14	17,5	
12 14 38	R1/4	R3/8	11	11,5	27,5	17	20	
12 14 12	R1/4	R1/2	11	14	31	22	38	
12 38 38	R3/8	R3/8	11,5	11,5	28	17	23	
12 38 12	R3/8	R1/2	11,5	14	31,5	22	40	
12 12 12	R1/2	R1/2	14	14	34	22	44	
12 12 34	R1/2	R3/4	14	16,5	37,5	27	69	
12 34 34	R3/4	R3/4	16,5	16,5	40	27	78	
12 3/4 1"	R3/4	R1"	16,5	19	42,5	34	112	
12 1" 1"	R1"	R1"	19	19	45,5	34	128	

RA 13

Manicotto

Joint Piece

Manchon

Muffe

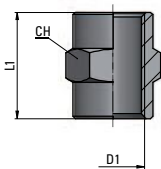

Tipo	D1	L1	CH	g	△
13 00 M5	M5x0,8	11	8	2	
13 00 18	G1/8	15	14	10,6	
13 00 14	G1/4	22	17	18,7	
13 00 38	G3/8	23	22	34,5	
13 00 12	G1/2	28	26	48,4	

RA 14

Riduzione F-M Conica

Taper Female-Male reducing connector

Réduction Femelle-Mâle, conique

Reduzierstück, Auf-Einschraub, kegelig

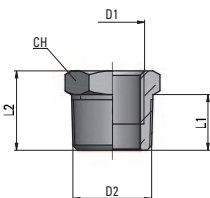

Tipo	D1	D2	L1	L2	CH	g	△
14 18 14	G1/8	R1/4	11	16	14	10,6	
14 18 38	G1/8	R3/8	11,5	16,5	17	20,7	
14 18 12	G1/8	R1/2	14	19,5	22	32,9	
14 14 38	G1/4	R3/8	11,5	16,5	17	12,6	
14 14 12	G1/4	R1/2	14	19,5	22	29,4	
14 38 12	G3/8	R1/2	14	19,5	22	23,3	
14 12 34	G1/2	R3/4	16,5	23,5	27	45	
14 12 1"	G1/2	R1"	19	27	34	132	
14 34 1"	G3/4	R1"	19	27	34	104	